

# 环保水处理 PVC-U 管材 / 管件 / 阀门

PVC-U PIPE/FITTING/VALVE

FOR ENVIRONMENTAL WATER TREATMENT



# CONTENTS

## 目录

ABOUT US 关于我们	01
CERTIFICATIONS 资质证书	03
PRODUCT CATEGORY 产品类别	05
APPLICATION 行业应用	06
Table of Product Standards-PVC-U/C Pipes and Fittings UPVC/CPVC 管材管件执行标准一览表	07
Standards of UPVC Material Testing UPVC 材料试验标准	07
Standards of CPVC Testing Material CPVC 材料试验标准	08
	
PIPES 管材	09
环保水处理 UPVC 管材系列和规格尺寸 SERIES AND SIZE OF UPVC PIPE FOR ENVIRONMENTAL WATER TREATMNT	10



PIPE FITTINGS 管件	11
45° 弯头 ELBOW 45°	12
90° 弯头 ELBOW 90°	13
正三通 TEE	14
异三通 REDUCING TEE	15
正四通 CROSS	17
异径 REDUCER	18
管堵 CAP	19
管箍 COUPLING	20
由任 (活接) UNION	21
内丝 FEMALE ADAPTOR	22
外丝 MALE ADAPTOR	23
单片式法兰 ONE-PIECE FLANGE	24
活套平承法兰 VANSTONE FLANGE	25
马鞍 (弧面) 接头 CAMBERED SURFACE ADAPTOR	26
卡套 (拷贝林) COUPLING (TYPE II)	27
卡套 (拷贝林) 接头 COUPLING ADAPTOR	28



VALVES 阀门	29
插口双由令球阀 SOCKET TRUE UNION BALL VALVE	31
单由令止回阀 SINGLE UNION CHECK VALVE	33
单由令底阀 SINGLE UNION BOTTOM VALVE	35
摆动式底阀 SWINGING BOTTOM VALVE	37
摆动式止回阀 SWINGING CHECK VALVE	39
手动通用蝶阀 GENERAL BUTTERFLY VALVE (HANDLED TYPE)	41
齿轮式通用蝶阀 GENERAL BUTTERFLY VALVE (GEARED TYPE)	43
取样阀 SAMPLING VALVE	45

## Professional strength builds easy life

专业实力构筑轻松生活



# ABOUT US

## 关于我们

环保水处理 PVC-U 管材 / 管件 / 阀门

PVC-U PIPE/FITTING/VALVE  
FOR ENVIRONMENTAL WATER TREATMENT

## EXPERT IN PIPING SYSTEM

管路系统的专家级工厂

重信求实 华生企业的灵魂  
开拓创新 永恒发展的动力

以质取胜、以质取信，为顾客提供满意的产品和服务。



### 公司简介

华生管道科技有限公司始建于1988年，坐落于江苏常州高新技术产业开发区，是一家集UPVC、CPVC、PE、PPH、PVDF等材质的工业、给水、环保水处理设备类塑料管道产品研发、制造于一体的管路系统专业生产企业。经过多年的探索与提升，目前华生已成为行业内的领先企业，是江苏省塑料管道系统工程技术中心依托单位，中国塑料加工工业协会塑料管道专业委员会成员单位，中国电子材料行业协会成员单位。中国氯碱工业协会成员单位，中国电子电路行业协会成员单位。

### 公司实力

公司占地面积20万平方米，拥有固定资产6亿元人民币。公司现有员工400多人，下设模具事业部、管路系统事业部、精密注塑事业部。原料混配系统6套，造粒生产线8条，管材挤出生产线30条，注塑机200多台，大型加工中心等机械加工设备80多台，年生产能力达60000吨。

### 资质 & 荣誉

目前公司已经通过ISO9001、ISO14001、OHSAS18001等体系的认证，以及美国卫生基金国际组织NSF认证。公司被认定为江苏省高新技术企业，“华生”商标荣获江苏省著名商标。拥有江苏省高新技术产品2项，授权专利30项，获得国家质量监督检验检疫总局颁发的《中华人民共和国特种设备制造许可证（压力管道元件）》和江苏省卫计委颁发的《涉水产品卫生行政许可批件》，并入选《全国水利系统优秀产品招标重点推荐目录》和《全国农村水利工程材料设备产品信息年报》。

# CERTIFICATIONS

## 资质证书

客户至上，优质高效，绿色环保，顾客满意。

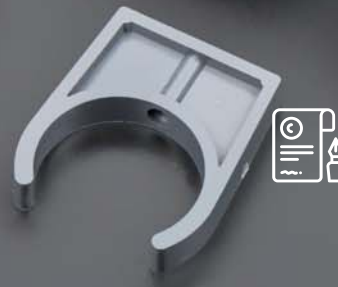

# PRODUCT CATEGORY

## 产品类别

### ▶ 给水、工业、环保水处理系列管材

DIN:20mm-800mm  
S4/S5/S6,3/S8/S10/S12,5/S16/S20  
ASTM:1/2"-24"  
SCH40/SCH80



管材 / PIPE

### ▶ 给水、工业、环保水处理系列管件

(PN10、PN12,5、PN16)  
柔性管件 (带胶圈管件) 63mm-355mm  
胶粘式管件 (PN10、PN12,5、PN16) 20mm-500mm  
SCH80 1/2"-16"



管件 / PIPE FITTING

### ▶ 阀门类

球阀 (插口、丝口)  
DIN:20mm-110mm; ASTM:1/2"-4"  
双由令球阀 (手柄式、气动式、电动式)  
DIN:20mm-110mm; ASTM:1/2"-4"; JIS:16A-100A  
蝶阀 (手柄式、齿轮式、气动式、电动式)  
DIN:63mm-400mm; ASTM:2"-16"; JIS:50A-318A  
隔膜阀 (法兰式、插口式、由令式)  
DIN:20mm-160mm; ASTM:1/2"-6"; JIS:16A-50A  
止回阀 (单由令式、双由令式、摆动式、旋启式)  
DIN:20mm-160mm; ASTM:1/2"-8"; JIS:16A-100A  
底阀 (由令式、摆动式)  
DIN:20mm-160mm



阀门 / VALVE

# APPLICATION

## 行业应用



管路系统的专家级工厂 EXPERT IN PIPING SYSTEM



- 化工行业
- 建筑行业
- 水处理行业
- 医疗制药行业
- 电子行业
- 冶金行业
- 食品加工行业
- 农业灌溉行业



## Table of Product Standards-UPVC/CPVC Pipes and Fittings

### UPVC/CPVC 管材管件执行标准一览表

种类 Type	执行标准 Product Standards
UPVC 给水管件 (国标) (DIN)UPVC Fittings For Water Supply	GB/T 10002.2-2003 BS EN ISO 1452
UPVC 化工管件 (国标) (DIN)UPVC Fittings For Industry	GB/T 4219.2-2015
UPVC 牙口式美标管件 (ASTM)Threaded Type UPVC Fittings	ASTM D2464
UPVC 承插式美标管件 (ASTM)Socket Type UPVC Fittings	ASTM D2467
CPVC 化工管件 (国标) (DIN)CPVC Fittings For Industry	GB/T 18998.3-2003
CPVC 牙口式美标管件 (ASTM)Threaded Type CPVC Fittings	ASTM F437
CPVC 承插式美标管件 (ASTM)Socket Type CPVC Fittings	ASTM F439
UPVC 给水管材 (国标) (DIN) UPVC Pipes For Water Supply	GB/T 10002.1-2006
UPVC 化工管材 (国标) (DIN) UPVC Pipes For Industry	GB/T 4219.1-2008
UPVC 美标 管材 (ASTM) UPVC Pipes	ASTM D 1785
CPVC 给水管材 (国标) (DIN) CPVC Pipes For Water Supply	GB/T 18993.2-2003
CPVC 化工管材 (国标) (DIN) CPVC Pipes For Industry	GB/T 18998.2-2003
CPVC 美标管材 (ASTM) CPVC Pipes	ASTM F441

## Standards of UPVC Material Testing

### UPVC 材料试验标准

指标名称 Index Name	单位 Unit	指标 Index	试验方法 Test method
密度 Density	kg/m <sup>3</sup>	1350-1460	按 GB/T 1033-1986 规定 A 法测定 Method A of GB 1033
维卡软化温度 Vicat Softening Temperature	°C	管材 ≥80 管件 ≥74	GB/T 8802-2001
静液压测试 Hydraulic Test		不破裂, 不渗水 No Breakage, no leakage	GB/T 6111-2003
纵向回缩率 Longitudinal Reversion	%	≤5	GB/T 6671-2001
二氯甲烷浸泡 Dichloromethane Soak		试样表面无损坏 No damage on surface of sampe	GB/T 13526-2007

## Standards of CPVC Testing Material

### CPVC 材料试验标准

指标名称 Index Name	单位 Unit	指标 Index	试验方法 Test method
密度 Density	kg/m <sup>3</sup>	1450-1650	GB/T 1033-1986 方法 A Method A of GB/T 1033-1986
维卡软化温度 (管材) Vicat Softening Temperature(Pipes)	°C	≥110	GB/T 8802-2001
维卡软化温度 (管件) Vicat Softening Temperature(Fittings)	°C	≥103	GB/T 8802-2001
纵向回缩率 Longitudinal Reversion	%	≤5	GB/T6671-2001 方法 B Method B of GB/T6671-2001
氯含量 (质量百分比) Chlorine Concentration (Mass Percent)	%	≥60	GB/T 7139-2002
静液压试验 Hydrostatic Test	--	无脱层, 无破碎 No leafing, no break	ISO 1167:1996
静液压状态下热稳定试验 Hydrostatic Reheat Test	--	无脱层, 无破碎 No leafing, no break	ISO 1167
落锤冲击试验 Drop Impact Test	Cal/g/°C	TIR≤10%	GB/T 14152
烘箱试验 Oven Test	MPa	无分层, 无开裂 No lamination, no crack	GB/T 8803
弹性模量 * Modulus of Elasticity	MPa	≥2660	ASTM D638
拉伸强度 * Tensile Strength	KJ/m <sup>2</sup>	≥56	ASTM D638
冲击强度 * Impact Strength	m/m°C	≥16	ASTM D256
线膨胀系数 * Coefficient of Linear Expansion	Cal/g/°C	3.4×10 <sup>-5</sup>	--
热传导率 * Thermal Conductivity	Cal/g/°C	0.14	ASTM C177
比热 * Specific Heat	Ω/cm	0.14	--
体电阻 * Bulk Resistance	AC, KV/mm	≥1015	--
介电强度 * Dielectric Strength	--	13	--
阻燃性 * Flame Retardant	--	自熄 Self-extinguish	UL-94

## SERIES AND SIZE OF UPVC PIPE FOR ENVIRONMENTAL WATER TREATMNT

### 环保水处理 UPVC 管材系列和规格尺寸

#### 管材介绍

##### 管材特点

1. 物化性能优良。用 UPVC 生产的管材及管件，耐腐蚀，抗冲强度高，流体阻力小（较同口径铸铁管流量提高 30%）。耐老化，使用寿命长（据权威机构测试资料说明，使用年限为 40-50 年），是建筑排水、化工排污的理想材料。
2. 质轻实用，安装方便。重量只有同口径铸铁管的 1/7，可大大加快工程进度和降低施工费用。
3. 内壁光滑，排水流畅，管道不易堵塞。检查口设计独特，检查操作方便，不需要任何工具。
4. 节约建筑费用。使用 UPVC 管比使用同样规格的铸铁管的综合造价低，维修费用低。

#### 产品参数

GB/T 4219.1-2008 单位: 毫米 unit:mm

公称外径 De Nominal Outside Diameter De	外形尺寸 Dimensions (mm)			
	S10/SDR21		S12.5 / SDR26	
	e <sub>min</sub>	公差 Tolerance	e <sub>min</sub>	公差 Tolerance
16	-	-	-	-
20	2.0	+0.4	-	-
25	2.0	+0.4	-	-
32	2.0	+0.4	-	-
40	2.0	+0.4	-	-
50	2.4	+0.5	-	-
63	3.0	+0.5	-	-
75	3.6	+0.6	-	-
90	4.3	+0.7	-	-
110	5.3	+0.8	4.2	+0.7
125	6.0	+0.8	4.8	+0.7
140	6.7	+0.9	5.4	+0.8
160	7.7	+1.0	6.2	+0.9
180	8.6	+1.1	6.9	+0.9
200	9.6	+1.2	7.7	+1.0
225	10.8	+1.3	8.6	+1.1
250	11.9	+1.4	9.6	+1.2
280	13.4	+1.6	10.7	+1.3
315	15.0	+1.7	12.1	+1.5

注 1: 考虑到安全性, 最小壁厚应不小于 2.0mm. The minimum wall thickness is no less than 2.0mm for security.

注 2: 除了有其他规定之外, 尺寸应与 GB/T10798 一致. The size should conform to GB/T10798 unless otherwise specified.

# 管材 PIPE

## ELBOW 45°

45°弯头

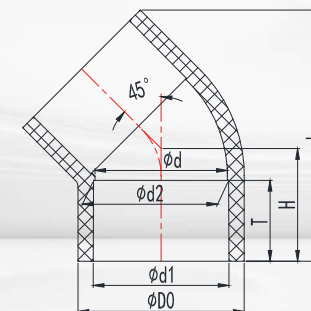

### 产品参数

尺寸 Size DN (De)	外形尺寸 Dimensions (mm)							公称压力 Nominal Pressure PN(kg/cm <sup>2</sup> )
	D0	d1	d2	d	T	H	L	
15(20)	26.30	20.30	19.95	18.00	16.20	22.10	46.90	16
20(25)	31.80	25.30	24.95	23.00	18.70	25.70	54.90	16
25(32)	38.60	32.30	31.90	30.00	22.20	30.60	66.20	16
32(40)	48.20	40.40	39.90	38.00	26.20	36.30	79.30	12.5
40(50)	58.30	50.40	49.90	48.00	31.20	43.30	95.70	12.5
50(63)	73.35	63.40	62.90	61.00	37.70	52.50	116.90	12.5
65(75)	86.75	75.40	74.90	70.90	43.70	64.60	142.50	12.5
80(90)	104.38	90.50	89.90	85.90	51.20	75.60	166.90	12.5
100(110)	124.42	110.60	109.90	103.90	61.20	89.20	197.60	12.5
De125	141.52	125.70	124.90	118.90	68.70	100.70	222.90	12.5
125(140)	158.58	140.80	139.90	133.90	76.20	112.40	248.90	12.5
150(160)	180.15	160.80	159.90	153.90	86.20	126.90	281.90	12.5
De200	226.58	201.00	199.90	193.50	106.20	157.10	349.50	12.5
200(225)	254.60	226.20	224.90	216.90	119.10	175.70	391.50	12.5
De250	270.90	251.15	249.41	247.00	132.00	193.30	432.20	10
250(280)	314.80	281.46	280.16	278.00	147.00	209.60	469.10	10
300(315)	344.50	316.55	315.05	312.00	165.00	233.50	541.20	10

# 管件 PIPE FITTING



## ELBOW 90°

### 90°弯头

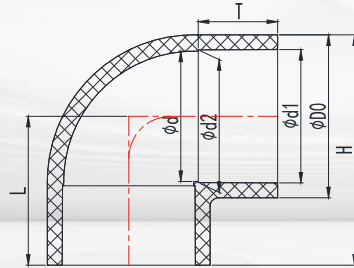

## TEE

### 正三通

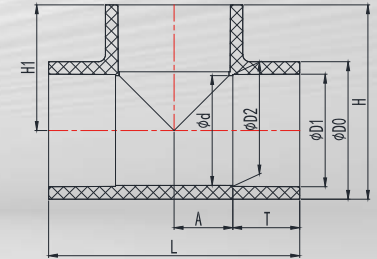
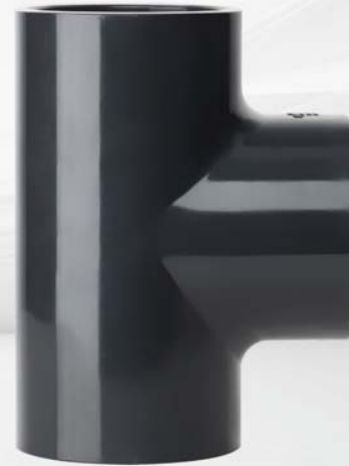

### 产品参数

尺寸 Size DN (De)	外形尺寸 Dimensions (mm)							公称压力 Nominal Pressure PN(kg/cm <sup>2</sup> )
	D0	d1	d2	d	T	L	H	
15(20)	26.30	20.30	19.95	18.00	16.20	27.70	40.85	16
20(25)	31.80	25.30	24.95	23.00	18.70	32.70	48.60	16
25(32)	38.60	32.30	31.90	30.00	22.20	39.70	59.00	16
32(40)	48.20	40.40	39.90	38.00	26.20	47.70	71.80	12.5
40(50)	58.30	50.40	49.90	48.00	31.20	57.70	86.85	12.5
50(63)	73.35	63.40	62.90	61.00	37.70	70.70	107.38	12.5
65(75)	86.75	75.40	74.90	70.90	43.70	82.50	125.88	12.5
80(90)	104.38	90.50	89.90	85.90	51.20	97.50	149.69	12.5
100(110)	124.42	110.60	109.90	103.90	61.20	117.50	179.71	12.5
De125	141.52	125.70	124.90	118.90	68.70	132.50	203.26	12.5
125(140)	158.58	140.80	139.90	133.90	76.20	148.00	227.29	12.5
150(160)	180.15	160.80	159.90	153.50	86.20	168.50	258.58	12.5
De200	226.58	201.00	199.90	193.50	106.20	208.00	321.29	12.5
200(225)	254.60	226.20	224.90	216.90	119.10	233.60	360.90	12.5
De250	271.40	251.15	249.41	247.00	132.00	261.00	396.70	10
250(280)	314.80	281.46	280.16	278.00	147.00	276.00	433.40	10
300(315)	344.50	316.55	315.05	312.00	165.00	326.50	498.75	10

### 产品参数

尺寸 Size DN (De)	外形尺寸 Dimensions (mm)								公称压力 Nominal Pressure PN(kg/cm <sup>2</sup> )
	D0	D1	D2	d	T	L	H1	H	
15(20)	26.30	20.30	19.95	18.00	16.20	55.40	27.70	40.85	16
20(25)	31.80	25.30	24.95	23.00	18.70	65.40	32.70	48.60	16
25(32)	38.60	32.30	31.90	30.00	22.20	79.40	39.70	59.00	16
32(40)	48.20	40.40	39.90	38.00	26.20	97.20	47.70	71.80	12.5
40(50)	58.30	50.40	49.90	48.00	31.20	114.50	57.70	86.85	12.5
50(63)	73.35	63.40	62.90	61.00	37.70	141.00	70.70	107.38	12.5
65(75)	86.75	75.40	74.90	70.90	43.70	165.00	82.50	125.88	12.5
80(90)	104.38	90.50	89.90	85.90	51.20	194.00	97.50	149.69	12.5
100(110)	124.42	110.60	109.90	103.90	61.20	234.00	117.50	179.71	12.5
De125	141.52	125.70	124.90	118.90	68.70	264.00	132.50	203.26	12.5
125(140)	158.58	140.80	139.90	133.90	76.20	296.00	148.00	227.29	12.5
150(160)	180.15	160.80	159.90	153.90	86.20	334.00	168.00	258.08	12.5
De200	226.58	201.00	199.90	193.50	106.20	415.00	208.00	321.29	12.5
200(225)	254.60	226.20	224.90	216.90	119.10	463.50	233.50	360.80	12.5
De250	272.00	251.15	249.41	247.00	132.00	522.00	261.00	397.00	10
250(280)	314.80	281.46	280.16	278.00	147.00	576.00	276.00	433.40	10
300(315)	344.50	316.55	315.05	312.00	165.00	653.00	298.75	498.75	10

## REDUCING TEE

### 异三通

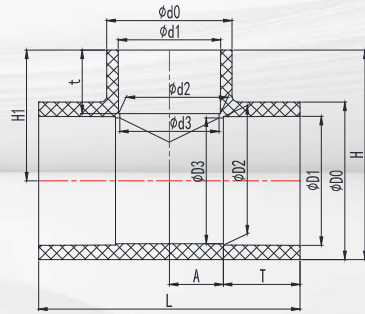

## 产品参数

尺寸 Size DN (De)	外形尺寸 Dimensions (mm)												公称压力 Nominal Pressure PN(kg/cm <sup>2</sup> )	
	D0	D1	D2	D3	d0	d1	d2	d3	T	t	H1	H		L
20X15(25*20)	31.80	25.25	24.95	23.00	26.30	20.30	19.95	18.00	18.70	16.20	30.20	46.10	60.40	16
25X20(32*25)	38.60	32.30	31.90	30.00	31.80	25.30	24.95	23.00	22.20	16.20	36.20	55.50	72.10	16
32X25(40*32)	48.20	40.35	39.90	38.00	38.60	32.30	31.90	30.00	26.20	22.20	43.70	67.80	87.40	12.5
40X25(50*32)	58.10	50.35	49.90	48.00	38.80	32.30	31.90	30.00	31.20	22.20	48.50	77.55	97.40	12.5
40X32(50*40)	58.30	50.35	49.90	48.00	48.20	40.35	39.90	38.00	31.20	26.20	52.70	81.85	65.25	12.5
50X25(63*32)	73.10	63.40	62.90	61.00	38.80	32.30	31.90	30.00	37.70	22.20	55.20	91.75	110.40	12.5
50X40(63*50)	73.35	63.40	62.90	61.00	61.90	50.35	49.90	48.00	37.70	31.20	64.20	100.88	127.70	12.5
65X25(75*32)	86.70	75.40	74.90	70.90	38.80	32.30	31.90	23.00	43.70	22.20	61.20	104.55	140.30	12.5
65X50(75*63)	86.75	75.40	74.90	70.90	77.50	63.40	62.90	61.00	43.70	37.70	77.30	120.68	152.20	12.5
80X25(90*32)	104.30	90.50	89.90	85.90	38.80	32.30	31.90	23.00	51.20	22.20	68.70	120.85	168.20	12.5
80X50(90*63)	104.30	90.50	89.90	85.90	73.10	63.40	62.90	61.00	51.20	37.70	84.20	136.35	168.20	12.5
80X65(90*75)	104.38	90.50	89.90	85.90	91.20	75.40	74.90	70.90	51.20	43.70	92.30	144.49	180.70	12.5
100X25(110*32)	124.40	110.60	109.90	103.90	38.80	32.30	31.90	23.00	61.20	22.20	77.70	139.9	190.00	12.5
100X40(110*50)	124.40	110.60	109.90	103.90	58.10	50.35	49.90	48.00	61.20	31.20	88.50	150.7	189.00	12.5
100X50(110*63)	124.40	110.60	109.90	103.90	73.10	63.40	62.90	61.00	61.20	37.70	95.00	157.2	190.00	12.5
100X80(110*90)	124.42	110.60	109.90	103.90	104.38	90.50	89.90	85.90	61.20	51.20	110.35	172.56	214.80	12.5
125X50(140*63)	158.50	140.75	139.90	133.90	73.10	63.40	62.90	61.00	76.20	37.70	113.50	192.75	247.00	12.5
125X100(140*110)	158.58	140.75	139.90	133.90	124.42	110.60	109.90	103.90	76.20	61.20	136.70	215.99	266.40	12.5
150X50(160*63)	180.60	160.80	159.90	153.90	73.10	63.40	62.90	61.00	86.20	37.70	126.00	216.3	286.00	12.5
150X100(160*110)	180.60	160.80	159.90	153.90	124.40	110.60	109.90	103.90	86.20	61.20	144.50	234.8	286.00	12.5
150X125(160*140)	180.15	160.80	159.90	153.90	158.58	140.75	139.90	133.90	86.20	76.20	161.50	251.58	315.50	12.5
De200X160	226.58	201.00	199.90	193.50	180.15	160.80	159.90	153.90	119.10	86.20	209.70	310.70	400.00	12.5
200X80(225*90)	254.60	226.20	224.90	216.90	104.30	90.50	89.90	85.90	118.70	51.20	168.50	295.8	384.00	12.5
200X150(225*160)	254.60	226.20	224.90	216.90	180.15	160.80	159.90	153.90	119.10	86.20	209.70	337.00	403.00	12.5
De250*110	272.00	251.15	249.41	247.00	120.50	110.42	109.92	108.00	62.00	132.00	191.00	327.00	377.00	10
De250*160	270.00	251.15	249.41	247.00	173.00	160.62	159.87	158.00	87.00	132.00	216.00	351.00	427.00	10
De250*200	274.10	251.15	249.41	247.00	220.00	200.90	199.85	197.00	107.00	132.00	236.00	373.05	474.00	10
De280*250	314.80	281.46	280.16	278.00	280.00	251.15	199.85	247.00	132.00	147.00	276.00	433.40	580.00	10
300X100(315*110)	344.50	316.55	315.05	312.00	125.75	110.42	109.92	108.00	62.00	165.00	223.50	395.75	448.00	10
300X150(315*160)	344.50	316.55	315.05	312.00	178.60	160.62	159.87	158.00	87.00	165.00	248.50	420.75	498.00	10
De315*200	344.50	316.55	315.05	312.00	220.90	200.90	199.85	197.00	107.00	165.00	268.50	440.75	538.00	10
De355*250	386.50	356.63	355.03	326.00	273.40	251.15	249.41	247.00	132.00	183.50	311.50	504.75	638.50	10

## CROSS

### 正四通

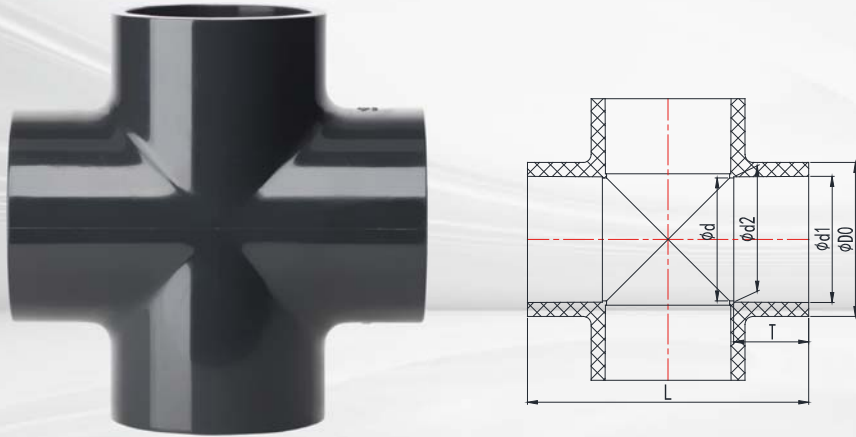

## REDUCER

### 异径

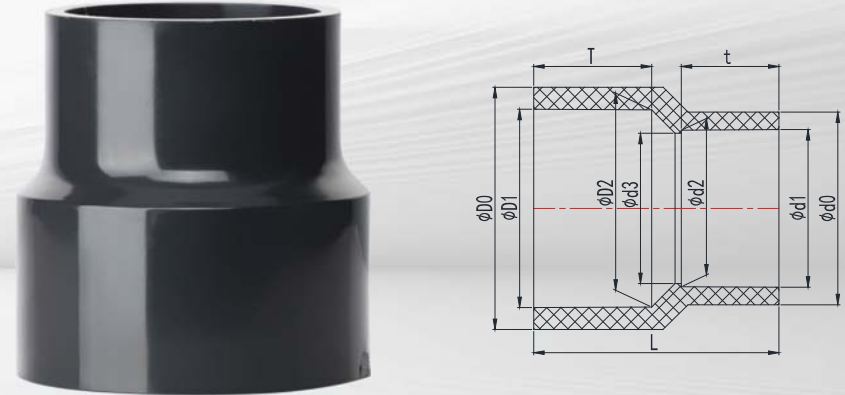

### 产品参数

尺寸 Size DN (De)	外形尺寸 Dimensions (mm)						公称压力 Nominal Pressure PN(kg/cm <sup>2</sup> )
	D0	d1	d2	d	T	L	
15(20)	26.30	20.30	19.95	18.00	16.20	55.40	12.5
20(25)	31.80	25.30	24.95	21.00	18.70	65.40	12.5
25(32)	38.60	32.30	31.90	28.00	22.20	79.40	12.5
32(40)	48.20	40.35	39.90	36.00	26.20	95.40	12.5
40(50)	58.30	50.35	49.90	46.00	31.20	115.40	12.5
50(63)	73.35	63.40	612.90	59.00	37.70	141.00	12.5
65(75)	86.75	75.40	74.90	70.90	43.70	165.00	12.5
80(90)	104.38	90.50	89.90	85.90	51.20	194.50	12.5
100(110)	124.42	110.60	109.90	103.90	61.20	234.50	12.5
De125	144.30	125.70	124.90	118.90	68.70	263.80	12.5
125(140)	158.58	140.75	139.90	133.90	76.20	295.00	12.5
150(160)	180.15	160.80	159.90	153.90	86.20	336.00	12.5
De200	230.00	201.00	199.90	193.90	106.20	414.00	16
200(225)	259.40	226.20	224.90	216.90	119.10	465.00	16
De250	287.90	251.30	249.90	241.40	131.65	515.50	16
250(280)	314.80	281.20	280.10	276.00	147.00	582.00	16
300(315)	354.00	316.70	314.90	307.00	164.30	643.00	16

### 产品参数

尺寸 Size DN (De)	外形尺寸 Dimensions (mm)										公称压力 Nominal Pressure PN(kg/cm <sup>2</sup> )
	D0	D1	D2	d0	d1	d2	d3	t	T	L	
20X15(25*20)	31.80	25.30	24.95	26.30	20.30	19.95	18.00	16.20	18.70	40.00	16
25X20(32*25)	38.60	32.30	31.90	31.80	25.30	24.95	23.00	18.70	22.20	47.40	16
32X25(40*32)	48.20	40.35	39.90	38.60	32.30	31.90	30.00	22.20	26.20	54.80	12.5
40X32(50*40)	58.30	50.35	49.90	48.20	40.35	39.90	38.00	26.20	31.20	65.00	12.5
50X25(63*32)	73.10	63.40	62.90	38.80	32.30	31.90	30.00	22.20	37.70	79.50	12.5
50X40(63*50)	73.35	63.40	62.90	61.90	58.30	49.90	48.00	31.20	37.70	77.70	12.5
65X25(75*32)	86.70	75.40	74.90	38.80	32.30	31.90	30.00	22.20	43.70	92.20	12.5
65X50(75*63)	86.75	75.40	74.90	77.50	73.35	62.90	61.00	37.70	43.70	92.50	12.5
80X65(90*75)	104.38	90.50	89.90	91.20	86.75	74.90	70.90	43.70	51.20	107.30	12.5
100X50(110*63)	124.40	110.60	109.90	73.10	63.40	62.90	61.00	37.70	61.20	127.40	12.5
100X80(110*90)	124.42	110.60	109.90	104.38	104.38	89.90	85.90	51.20	61.20	127.40	12.5
125X100(140*110)	158.58	140.75	139.90	124.42	110.60	109.90	103.90	43.70	76.20	157.70	12.5
150X100(160*110)	180.60	160.70	159.90	124.40	110.60	109.90	103.90	43.70	87.00	177.80	12.5
150X125(160*140)	180.15	160.70	159.90	158.58	140.75	139.90	133.90	51.20	87.00	177.30	12.5
De200*160	226.58	201.00	199.90	180.15	160.80	159.90	153.90	86.20	106.20	217.50	12.5
200X150(225*160)	226.58	226.20	224.90	180.15	160.80	159.90	153.90	86.20	119.10	242.50	12.5
250*200	270.00	251.15	249.41	217.20	200.90	199.85	197.00	107.00	132.00	272.00	10
280*250	315.50	281.46	280.16	280.40	251.15	249.41	247.00	132.00	147.00	304.00	10
315*250	342.80	316.55	315.05	273.70	251.15	249.41	247.00	132.00	165.00	351.00	10

## CAP 管堵

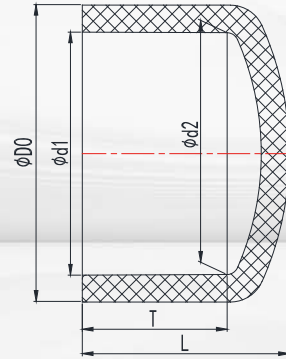

## COUPLING 管箍

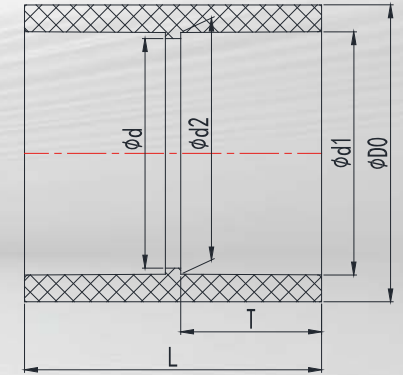

### 产品参数

尺寸 Size DN (De)	外形尺寸 Dimensions (mm)					公称压力 Nominal Pressure PN(kg/cm <sup>2</sup> )
	D0	d0	d1	d2	d	
15(20)	26.30	20.30	19.95	16.20	21.90	16
20(25)	31.80	25.30	24.95	18.70	25.70	16
25(32)	39.90	32.30	31.90	22.20	30.70	16
32(40)	49.70	40.40	39.90	26.20	36.90	16
40(50)	61.90	50.40	49.90	31.20	44.70	16
50(63)	77.90	63.40	62.90	37.70	54.00	16
65(75)	91.20	75.40	74.90	43.70	62.60	16
80(90)	107.60	90.50	89.90	51.20	73.30	16
100(110)	127.00	110.60	109.90	61.20	84.50	16
De125	144.30	125.70	124.90	68.70	96.10	16
125(140)	161.60	140.80	139.90	76.20	109.70	16
150(160)	184.60	160.80	159.90	86.20	126.20	16
De180	202.60	180.90	179.90	97.00	142.90	16
De200	230.50	201.00	199.90	106.20	151.10	16
200(225)	259.40	226.20	224.90	119.10	170.40	16
De250	273.70	251.15	249.41	132.00	185.00	10
250(280)	315.00	281.46	280.16	147.00	213.00	10
300(315)	343.50	316.55	315.05	165.00	216.00	10

### 产品参数

尺寸 Size DN (De)	外形尺寸 Dimensions (mm)					公称压力 Nominal Pressure PN(kg/cm <sup>2</sup> )	
	D0	d1	d2	d	T		L
15(20)	26.30	20.30	19.95	18.00	16.20	34.40	16
20(25)	31.80	25.30	24.95	23.00	18.70	39.00	16
25(32)	38.60	32.30	31.90	30.00	22.20	46.40	16
32(40)	48.20	40.40	39.90	38.00	26.20	54.40	12.5
40(50)	58.30	50.40	49.90	48.00	31.20	64.40	12.5
50(63)	73.35	63.40	62.90	61.00	37.70	77.10	12.5
65(75)	86.75	75.40	74.90	68.20	43.70	90.00	12.5
80(90)	104.38	90.50	89.90	83.80	51.20	106.40	12.5
100(110)	124.42	110.60	109.90	103.00	61.20	128.30	12.5
De125	141.52	125.70	124.90	118.60	68.70	144.00	12.5
125(140)	158.58	140.80	139.90	133.80	76.20	159.50	12.5
150(160)	180.15	160.80	159.90	153.80	86.20	179.70	12.5
De200	226.58	201.00	199.90	193.50	106.20	217.50	12.5
200(225)	254.60	226.20	224.90	216.90	119.10	243.00	12.5
De250	269.80	251.15	249.41	247.00	132.00	279.00	10
250(280)	314.80	281.46	280.16	278.00	147.00	299.50	10
300(315)	343.70	316.55	315.05	312.00	165.00	343.00	10

## UNION

由任 (由令)



## FEMALE ADAPTOR

内丝

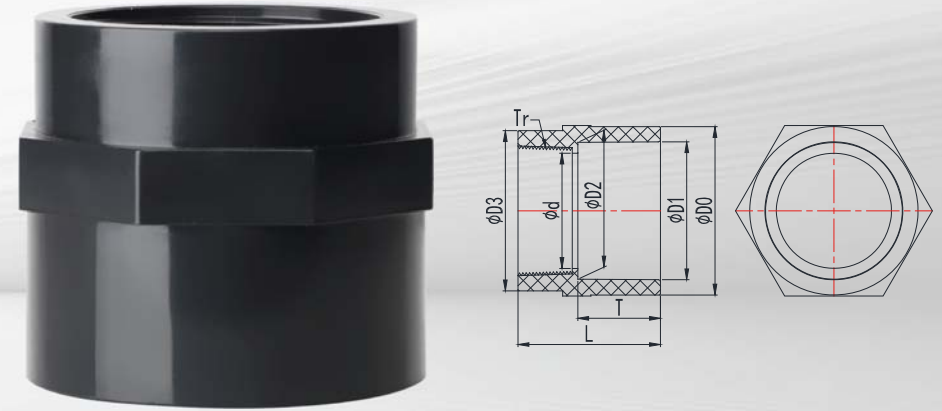

### 产品参数

尺寸 Size DN (De)	外形尺寸 Dimensions (mm)							公称压力 Nominal Pressure PN(kg/cm <sup>2</sup> )
	D0	d0	d1	d2	d	T	L	
15(20)	47.00	26.80	20.30	19.95	15.50	16.50	41.50	10
20(25)	53.90	32.00	25.30	24.95	20.00	19.00	48.00	10
25(32)	67.00	40.30	32.30	31.90	26.00	22.50	55.00	10
32(40)	78.50	49.10	40.35	39.90	34.00	26.50	63.50	10
40(50)	93.00	61.60	50.35	49.90	43.00	31.50	75.50	10
50(63)	110.60	76.00	63.40	62.90	56.00	38.00	89.50	10
65(75)	130.00	89.60	75.40	74.90	67.00	44.00	102.00	10
80(90)	147.50	105.50	90.50	89.90	82.00	51.50	120.00	10
100(110)	173.00	126.50	110.60	109.90	102.00	61.50	140.00	10

### 产品参数

尺寸 Size DN (De)	外形尺寸 Dimensions (mm)								公称压力 Nominal Pressure PN(kg/cm <sup>2</sup> )
	D0	D1	D2	D3	d	T	L	Tr 螺纹	
15(20)	27.10	20.30	19.95	27.60	16.50	16.50	33.50	1/2"	16
20(25)	32.50	25.30	24.95	33.60	22.00	19.00	37.00	3/4"	16
25(32)	40.30	32.30	31.90	41.30	28.00	22.50	42.20	1"	16
32(40)	49.50	40.35	39.90	51.10	36.00	26.50	49.00	1-1/4"	16
40(50)	61.60	50.35	49.90	59.00	42.00	31.50	54.00	1-1/2"	16
50(63)	77.40	63.40	62.90	73.60	53.00	38.00	65.50	2"	16
65(75)	90.40	75.40	74.90	90.20	68.00	44.00	76.00	2-1/2"	16
80(90)	106.50	90.50	89.90	107.60	80.00	51.50	86.50	3"	16
100(110)	126.90	110.60	109.90	129.40	104.50	61.50	103.00	4"	16

## MALE ADAPTOR

外丝

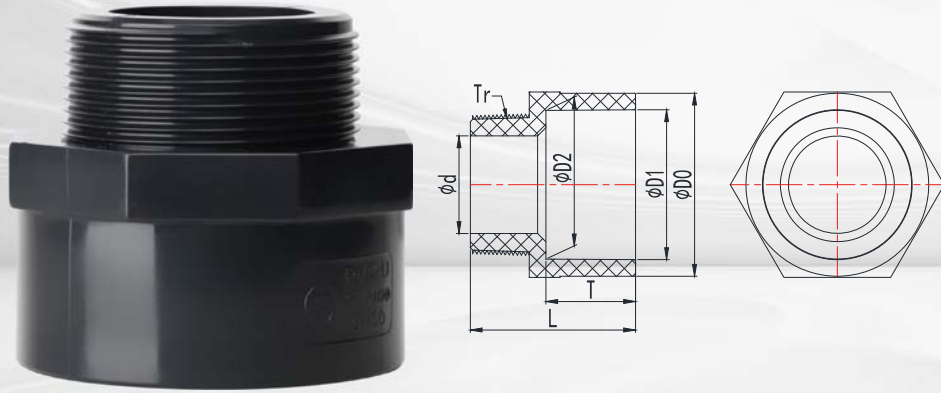

### 产品参数

尺寸 Size DN (De)	外形尺寸 Dimensions (mm)							公称压力 Nominal Pressure PN(kg/cm <sup>2</sup> )
	D0	D1	D2	d	T	L	Tr 螺纹	
15(20)	26.80	20.30	19.95	11.30	16.50	35.00	1/2"	16
20(25)	32.50	25.30	24.95	16.10	19.00	38.50	3/4"	16
25(32)	40.30	32.30	31.90	21.40	22.50	44.50	1"	16
32(40)	49.50	40.35	39.90	28.80	26.50	51.00	1-1/4"	16
40(50)	61.60	50.35	49.90	32.50	31.50	56.50	1-1/2"	16
50(63)	77.00	63.40	62.90	41.30	38.00	69.40	2"	16
65(75)	90.40	75.40	74.90	55.80	44.00	79.90	2-1/2"	16
80(90)	106.50	90.50	89.90	67.30	51.50	91.50	3"	16
100(110)	126.90	110.60	109.90	91.60	61.50	108.00	4"	16

## ONE-PIECE FLANGE

单片式法兰

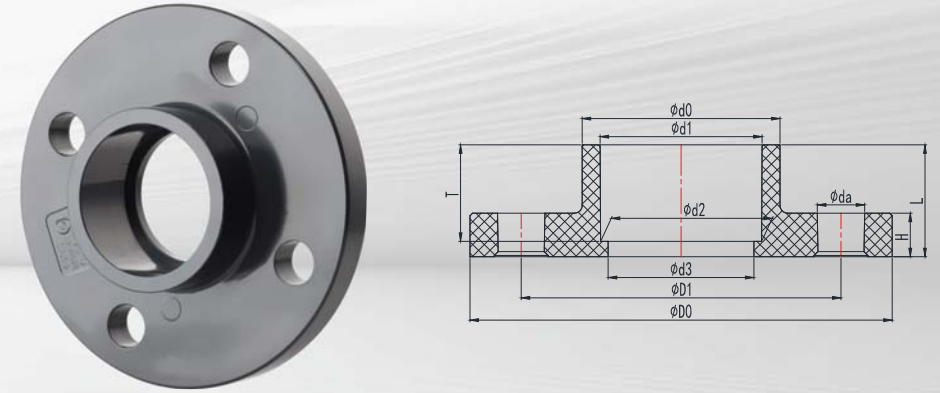

### 产品参数

尺寸 Size DN (De)	外形尺寸 Dimensions (mm)											公称压力 Nominal Pressure PN(kg/cm <sup>2</sup> )
	D0	D1	d0	d1	d2	d3	da	T	H	L	螺孔数 n	
15(20)	95.00	65.00	26.80	20.30	19.95	16.00	14.00	16.20	12.40	20.20	4	16
20(25)	105.00	75.00	32.50	25.30	24.95	21.00	14.00	18.70	13.50	22.70	4	16
25(32)	115.00	85.00	40.30	32.30	31.90	28.00	14.00	22.20	15.00	26.20	4	16
32(40)	140.00	100.00	49.30	40.35	39.90	36.00	18.00	26.20	14.40	31.20	4	16
40(50)	150.00	110.00	61.60	50.35	49.90	46.00	18.00	31.20	15.50	36.20	4	16
50(63)	165.00	125.00	77.40	63.40	62.90	57.00	18.00	37.70	15.50	43.70	4	16
65(75)	185.00	145.00	90.40	75.40	74.90	69.00	18.00	43.70	17.30	50.20	4	16
80(90)	200.00	160.00	106.50	90.50	89.90	83.00	18.00	51.20	18.50	58.70	8	16
100(110)	220.00	180.00	126.90	110.60	109.90	103.00	18.00	61.20	20.30	68.70	8	16
De125	250.00	210.00	144.00	125.70	124.90	117.00	18.00	68.70	22.00	77.20	8	16
125(140)	250.00	210.00	161.30	140.75	139.90	131.50	18.00	76.20	22.20	84.70	8	16
150(160)	285.00	240.00	184.30	160.80	159.90	151.00	22.00	86.20	25.00	95.70	8	16
De180	285.00	240.00	202.60	180.80	179.90	166.00	22.00	97.00	25.50	115.00	8	16
De200	340.00	295.00	227.00	201.00	199.90	190.00	22.00	106.20	26.30	116.20	8	10
200(225)	340.00	295.00	254.10	226.20	224.90	216.00	22.00	119.10	27.00	129.70	8	10
De250	394.00	350.00	272.50	251.15	249.41	247.00	22.00	132.00	31.00	156.00	12	10
250(280)	403.00	355.00	303.90	281.46	280.16	278.00	22.00	147.00	29.70	167.00	12	10

## VANSTONE FLANGE

### 活套平承法兰

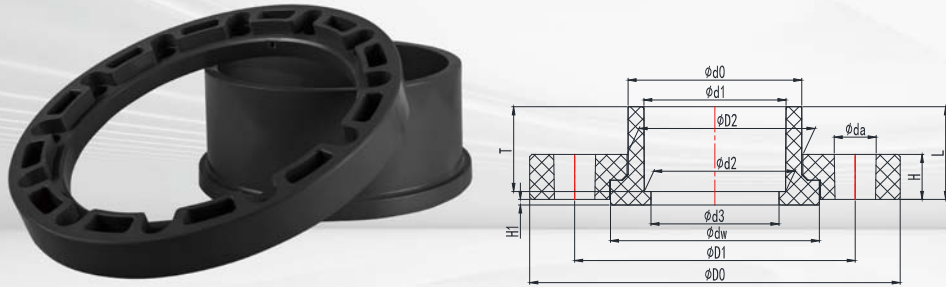

## CAMBERED SURFACE ADAPTOR

### 马鞍（弧面）接头



### 产品参数

尺寸 Size DN (De)	外形尺寸 Dimensions (mm)														公称压力 Nominal Pressure PN(kg/cm <sup>2</sup> )
	D0	D1	D2	d0	d1	d2	d3	dw	da	T	H1	H	L	螺孔数 n	
15(20)	95.00	65.00	31.00	30.50	20.30	19.95	16.00	37.60	14.00	23.22	2.50	13.00	24.70	4	16
20(25)	105.00	75.00	37.90	36.90	25.35	24.95	20.60	47.00	14.00	26.40	2.50	14.00	27.90	4	16
25(32)	115.00	85.00	45.70	44.70	32.35	31.95	27.00	56.00	14.00	29.58	2.50	15.00	31.08	4	16
32(40)	140.00	100.00	55.00	54.00	40.40	39.95	36.00	64.00	18.00	32.75	2.50	15.00	35.25	4	16
40(50)	150.00	110.00	62.60	61.60	50.35	49.90	45.00	74.00	18.00	31.20	2.50	18.00	33.70	4	16
50(63)	165.00	125.00	78.40	77.40	63.40	62.90	57.00	93.00	18.00	37.70	2.50	20.00	41.20	4	16
65(75)	185.00	145.00	91.40	90.40	75.40	74.90	69.00	110.00	18.00	43.70	2.50	23.00	47.20	4	16
80(90)	200.00	160.00	107.50	106.50	90.50	89.90	83.00	126.00	18.00	51.20	2.50	26.00	55.70	8	16
100(110)	220.00	180.00	127.90	126.90	110.60	109.90	103.00	147.00	18.00	61.20	2.50	28.00	65.70	8	16
De125	250.00	210.00	145.00	144.00	125.70	124.90	117.00	164.00	18.00	68.70	2.50	29.00	74.20	8	16
125(140)	250.00	210.00	162.30	161.30	140.75	139.90	131.50	181.00	18.00	76.20	2.50	30.00	81.70	8	16
150(160)	285.00	240.00	186.30	184.30	160.80	159.90	151.00	204.00	22.00	86.20	3.00	32.00	92.20	8	16
De200	340.00	295.00	229.00	227.00	201.00	199.90	190.00	256.00	22.00	106.20	3.00	36.00	112.20	8	10
200(225)	340.00	295.00	256.10	254.10	226.20	224.90	216.00	271.00	22.00	119.10	3.00	38.00	127.70	8	10
De250	393.00	350.00	277.00	275.00	251.15	249.41	247.00	303.00	22.00	132.00	22.50	34.00	138.00	12	10
250(280)	397.00	350.00	308.00	305.40	281.46	280.16	278.00	324.50	22.00	147.00	22.00	35.00	162.00	12	10
300(315)	445.00	400.00	353.50	346.30	316.55	315.05	312.00	378.50	22.00	165.00	30.00	40.00	157.70	12	10

### 产品参数

尺寸 Size DN (De)	外形尺寸 Dimensions (mm)						
	d	D	D1	d1	R	H	L
90*32	38.00	32.00	28.00	60.00	45.00	25.00	22.00
110*32	38.00	32.00	28.00	60.00	55.00	25.00	22.00
110*63	71.00	63.00	60.00	100.00	55.00	41.00	38.00
140*63	71.00	63.00	60.00	100.00	70.00	41.00	38.00
160*63	71.00	63.00	60.00	100.00	80.00	41.00	38.00
225*63	71.00	63.00	60.00	100.00	112.50	41.00	38.00
250*63	71.00	63.00	60.00	100.00	125.00	41.00	38.00
250*75	71.00	84.00	70.00	114.00	125.00	41.00	38.00
280*63	71.00	63.00	60.00	100.00	140.00	41.00	38.00
315*63	71.00	63.00	60.00	100.00	157.50	41.00	38.00

## COUPLING (TYPE II)

卡套 (拷贝林)

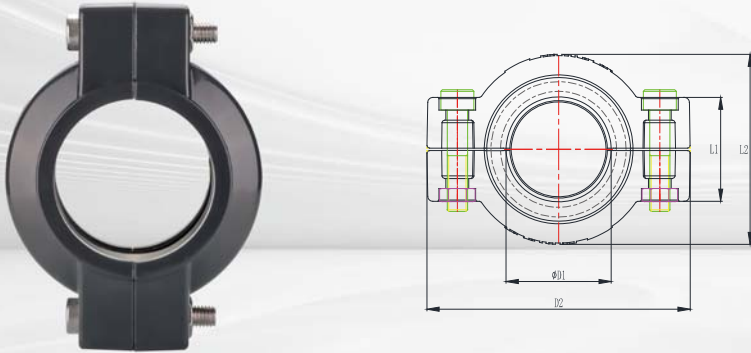

## COUPLING ADAPTOR

卡套 (拷贝林) 接头

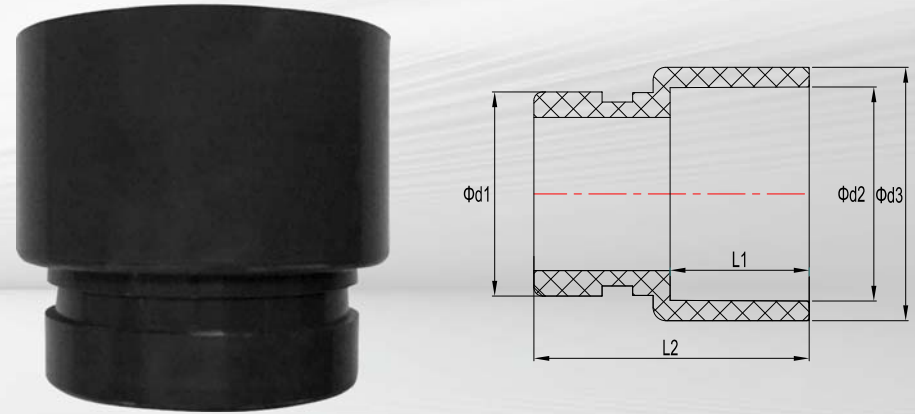

### 产品参数

尺寸 Size DN (De)	外形尺寸 Dimensions (mm)			
	D1	D2	L1	L2
32	42	104	41	74
40	48	110	41	80
50	60	122	41	92
65	73	135	41	105
80	89	151	41	121
100	114	176	41	146

### 产品参数

尺寸 Size DN (De)	外形尺寸 Dimensions (mm)				
	d1	d2	d3	L1	L2
DN32/De32	42	32	40	22	50
DN40/De40	48	40	50	26	54
DN40/De50	48	50	60	33	65
DN50/De50	60	50	62	33	61
DN50/De63	60	63	73	38	73
DN65/De75	73	75	86	44	78
DN80/De90	89	90	104	51	86
DN100/De110	114	110	124	61	96



# 阀门 VALVE

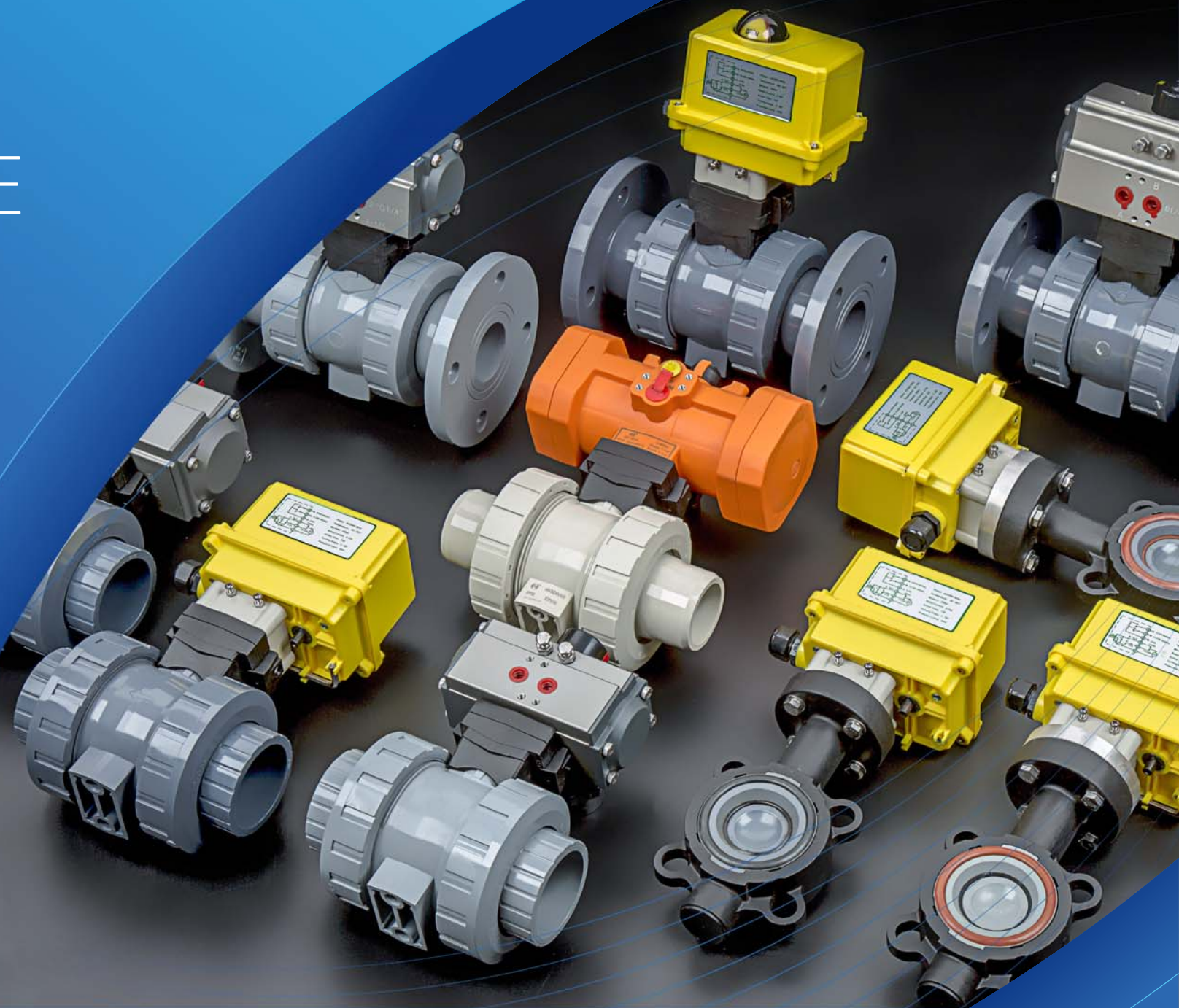

## SOCKET TRUE UNION BALL VALVE

### 插口双由令球阀

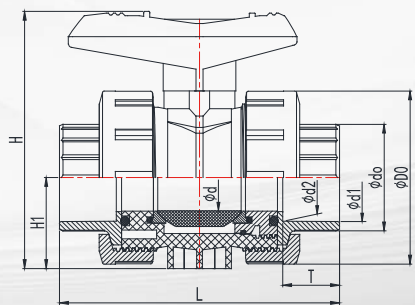

### 产品介绍

#### 阀门描述 Valve description

1. 材质: PVC-U  
Material: PVC-U
2. 尺寸: DN15-100  
Size: DN15-100
3. 标准: 国标  
Standard: DIN
4. 连接: 插口  
Connection: socket
5. 颜色: 把手红色, 本体: 深灰  
Color: handle red, body: dark gray

#### 产品特性 Product Features

1. 符合饮用水标准  
Meet drinking water standards
2. 开关扭力小  
Switch torque is small
3. 简单经济  
Simple economy
4. 材料经过纳米改性, 提高产品的耐压性及抗冲击性  
The material is nano-modified to improve the pressure resistance and impact resistance of the product
5. 阀体加厚处理, 抗压性能高  
Thickened valve body for high compression resistance
6. 阀门出厂 100% 压力测试  
Valve factory 100% pressure test

### 产品参数

尺寸 Size Dn(De)	外形尺寸 Dimensions (MM)								
	D0	d0	d1	d2	d	T	H1	H	L
15(20)	51.50	27.40	20.30	19.95	15.50	17.00	26.30	82.80	95.50
20(25)	59.00	32.70	25.30	24.95	20.50	19.50	30.60	92.80	109.10
25(32)	70.00	41.30	32.30	31.90	26.00	23.00	39.10	109.20	122.60
32(40)	85.40	49.60	40.35	39.90	33.00	27.00	44.20	131.80	147.30
40(50)	98.90	60.20	50.35	49.90	39.00	32.00	52.20	143.20	158.80
50(63)	122.20	76.00	63.40	62.90	51.00	38.50	71.30	175.70	182.80
65(75)	158.60	89.60	75.40	74.90	64.00	44.50	82.80	231.50	234.00
80(90)	192.10	105.40	90.50	89.90	81.00	52.00	99.30	260.60	255.00
100(110)	223.60	128.40	110.60	109.90	99.00	62.00	115.20	292.10	297.00

序号 NO.	名称 Name	数量 Quantity	材料 Material
01	手柄 Lever	1	PVC-U/PP+GF30%
02	连接杆 Shaft	1	PVC-U
03	螺帽 Nut	2	PVC-U
04	承口 Faucet	2	PVC-U
05	阀体 Body	1	PVC-U
06	球心 Ball	1	PVC-U
07	止泻圈 Ball Seat	2	TPE+PP
08	O型圈 1 O-ring1	2	EPDM
09	O型圈 2 O-ring2	2	EPDM
10	调节单盖 Seal Carrier	1	PVC-U
11	O型圈 3 O-ring3	1	EPDM
12	O型圈 4 O-ring4	2	EPDM

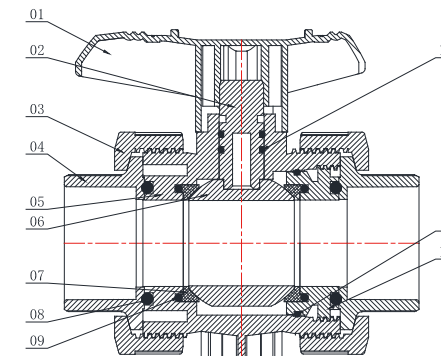

# SINGLE UNION CHECK VALVE

## 单由令止回阀

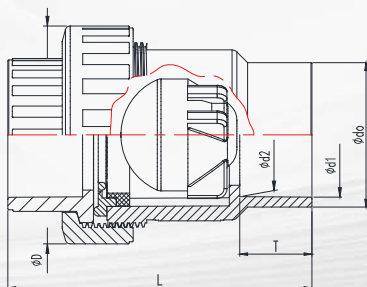

### 产品介绍

#### 阀门描述 Valve description

1. 材质: PVC-U/C  
Material: PVC-U/C
2. 尺寸: DN15-100  
Size: DN15-100
3. 标准: 国标  
Standard: DIN
4. 连接: 插口  
Connection: socket
5. 颜色: 深灰  
Color: dark gray

#### 产品特性 Product Features

1. 符合饮用水标准  
Meet drinking water standards
2. 实心·内球, 止水效果好  
Solid inner ball, good water stop effect
3. 部件可更换, 简单经济  
Parts can be replaced, simple and economical
4. 材料经过纳米改性, 提高产品的耐压性及抗冲击性  
The material is nano-modified to improve the pressure resistance and impact resistance of the product
5. 阀体加厚处理, 抗压性能高  
Thickened valve body for high compression resistance
6. 阀门出厂 100% 压力测试  
Valve factory 100% pressure test

### 产品参数

尺寸 Size De	外形尺寸 Dimensions (mm)						工作压力 Working pressure PN(kg/cm <sup>2</sup> )	最低开启压力 Minimum opening pressure PN(kg/cm <sup>2</sup> )
	D	d0	d1	d2	T	L		
15(20)	47.00	26.90	20.30	19.95	16.50	77.50	10	0.15~0.3
20(25)	53.90	32.50	25.30	24.95	19.00	94.50	10	0.15~0.3
25(32)	67.00	40.30	32.30	31.90	22.50	111.00	10	0.15~0.3
32(40)	78.50	49.40	40.35	39.90	26.50	129.00	10	0.15~0.3
40(50)	93.20	61.60	50.35	49.90	31.50	143.00	10	0.15~0.3
50(63)	110.60	73.40	63.40	62.90	36.70	154.70	10	0.15~0.3
65(75)	130.60	89.60	75.40	74.90	44.00	185.40	10	0.15~0.3
80(90)	148.40	105.50	90.50	89.90	51.50	213.70	10	0.15~0.3
100(110)	173.40	126.50	110.60	109.90	61.50	238.40	10	0.15~0.3

序号 No.	名称 Name	数量 Quantity	材料 Material
01	承口 Faucet	1	PVC-U/C
02	螺帽 Nut	1	PVC-U/C
03	橡胶圈 Rubber Ring	1	EPDM/FPM
04	定位圈 Located Ring	1	PVC-U/C
05	阀芯 Ball	1	PVC-U/C
06	阀体 Body	1	PVC-U/C

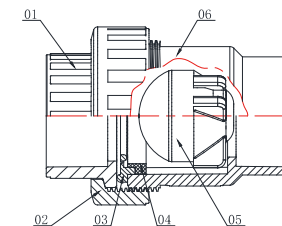

## SINGLE UNION BOTTOM VALVE

### 单由令底阀

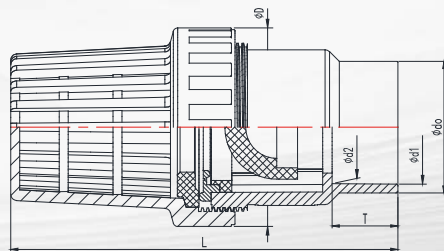

### 产品介绍

#### 阀门描述 Valve description

1. 材质: PVC-U/C  
Material: PVC-U/C
2. 尺寸: DN15-50  
Size: DN15-50
3. 标准: 国标  
Standard: DIN
4. 连接: 插口  
Connection: socket
5. 颜色: 深灰  
Color: dark gray

#### 产品特性 Product Features

1. 符合饮用水标准  
Meet drinking water standards
2. U型-内球, 止水效果好  
U-shaped inner ball, good water stop effect
3. 部件可更换, 简单经济  
Parts can be replaced, simple and economical
4. 材料经过纳米改性, 提高产品的耐压性及抗冲击性  
The material is nano-modified to improve the pressure resistance and impact resistance of the product
5. 阀体加厚处理, 抗压性能高  
Thickened valve body for high compression resistance
6. 阀门出厂 100% 压力测试  
Valve factory 100% pressure test

### 产品参数

尺寸 Size DN (De)	外形尺寸 Dimensions (mm)						工作压力 Working pressure PN(kg/cm <sup>2</sup> )	最低开启压力 Minimum opening pressure PN(kg/cm <sup>2</sup> )
	D	d0	d1	d2	T	L		
15(20)	47.00	27.90	20.30	19.96	16.50	113.00	10	0.15~0.3
20(25)	53.90	32.50	25.30	24.95	19.00	132.40	10	0.15~0.3
25(32)	67.00	40.30	32.30	31.90	22.50	145.70	10	0.15~0.3
32(40)	78.50	49.30	40.35	39.90	26.50	177.40	10	0.15~0.3
40(50)	93.00	61.60	50.35	49.90	31.50	201.60	10	0.15~0.3
50(63)	110.60	74.00	63.40	62.90	36.70	215.80	10	0.15~0.3

序号 No.	名称 Name	数量 Quantity	材料 Material
01	网罩 Wash Enclosure	1	PVC-U/C
02	垫圈 Washer	1	PVC-U/C
03	胶圈 Ring	1	EPDM/FPM
04	定位圈 Located Ring	1	PVC-U/C
05	阀芯 Ball	1	PVC-U/C
06	阀体 Body	2	PVC-U/C

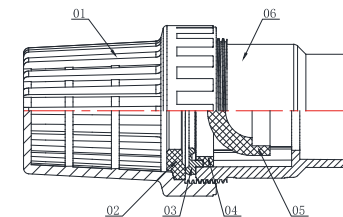

## SWINGING BOTTOM VALVE

### 摆动式底阀

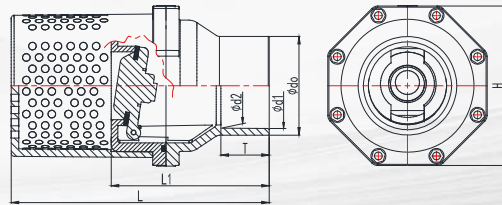

### 产品介绍

#### 阀门描述 Valve description

1. 材质: PVC-U/C  
Material: PVC-U/C
2. 尺寸: DN65-150  
Size: DN65-150
3. 标准: 国标  
Standard: DIN
4. 连接: 插口  
Connection: socket
5. 颜色: 深灰  
Color: dark gray

#### 产品特性 Product Features

1. 符合饮用水标准  
Meet drinking water standards
2. 部件可更换, 简单经济  
Parts can be replaced, simple and economical
3. 材料经过纳米改性, 提高产品的耐压性及抗冲击性  
The material is nano-modified to improve the pressure resistance and impact resistance of the product
4. 阀体加厚处理, 抗压性能高  
Thickened valve body for high compression resistance
5. 阀门出厂 100% 压力测试  
Valve factory 100% pressure test

### 产品参数

尺寸 Size DN (De)	外形尺寸 Dimensions (mm)							工作压力 Working pressure PN(kg/cm <sup>2</sup> )	最低开启压力 Minimum opening pressure PN(kg/cm <sup>2</sup> )
	d0	d1	d2	T	L1	L	H		
65(75)	88.20	75.40	74.90	43.70	160.00	266.00	169.00	6	0.15~0.3
80(90)	104.60	90.50	89.90	51.20	167.50	273.50	169.00	6	0.15~0.3
100(110)	125.40	110.60	109.90	61.20	218.00	379.00	206.00	6	0.15~0.3
De125(125)	145.50	125.70	124.90	68.70	215.50	386.50	206.00	6	0.15~0.3
125(140)	164.00	140.75	139.90	76.30	294.80	496.30	285.00	6	0.15~0.3
150(160)	186.00	160.80	159.90	87.00	304.50	505.80	285.00	6	0.15~0.3

序号 No.	名称 Name	数量 Quantity	材料 Material
01	漏体 Drain Body	1	PVC-U/C
02	阀体 Body	1	PVC-U/C
03	胶圈 1 Ring1	1	EPDM/FPM
04	活板 Trap	1	PVC-U/C
05	固定块 Fixed Block	2	PVC-U/C
06	胶圈 2 Ring2	1	EPDM/FPM
07	阀盖 Cover	1	PVC-U/C
08	螺栓 Bolt	12	Stainless steel
09	螺母 Nut	12	Stainless steel
10	垫片 Gasket	12	Stainless steel

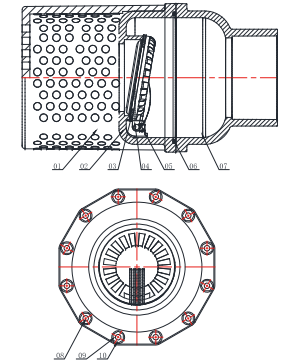

# SWINGING CHECK VALVE

## 摆动式止回阀

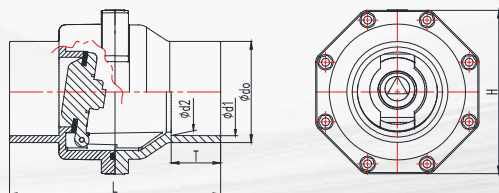

### 产品介绍

#### 阀门描述 Valve description

1. 材质: PVC-U/C  
Material: PVC-U/C
2. 尺寸: DN65-150  
Size: DN65-150
3. 标准: 国标  
Standard: DIN
4. 连接: 插口  
Connection: socket
5. 颜色: 深灰  
Color: dark gray

#### 产品特性 Product Features

1. 符合饮用水标准  
Meet drinking water standards
2. 部件可更换, 简单经济  
Parts can be replaced, simple and economical
3. 材料经过纳米改性, 提高产品的耐压性及抗冲击性  
The material is nano-modified to improve the pressure resistance and impact resistance of the product
4. 阀体加厚处理, 抗压性能高  
Thickened valve body for high compression resistance
5. 阀门出厂 100% 压力测试  
Valve factory 100% pressure test

### 产品参数

尺寸 Size DN (De)	外形尺寸 Dimensions (mm)						工作压力 Working pressure PN(kg/cm²)	最低开启压力 Minimum opening pressure PN(kg/cm²)
	d0	d1	d2	T	L	H		
65(75)	88.20	75.40	74.90	43.70	207.10	169.00	6	0.15~0.3
80(90)	104.60	90.50	89.90	51.20	218.70	169.00	6	0.15~0.3
100(110)	125.40	110.60	109.90	61.20	268.00	206.00	6	0.15~0.3
De125(125)	145.50	125.70	124.90	68.70	283.00	206.00	6	0.15~0.3
125(140)	164.00	140.75	139.90	76.30	369.30	285.00	6	0.15~0.3
150(160)	186.00	160.80	159.90	87.00	390.00	285.00	6	0.15~0.3

序号 No.	名称 Name	数量 Quantity	材料 Material
01	阀体 Body	1	PVC-U/C
02	胶圈 1 Ring1	1	EPDM/FPM
03	活板 Trap	1	PVC-U/C
04	胶圈 2 Ring2	1	EPDM/FPM
05	阀盖 Cover	1	PVC-U/C
06	螺栓 Bolt	8	Stainless steel
07	螺母 Nut	8	Stainless steel
08	垫片 Gasket	8	Stainless steel

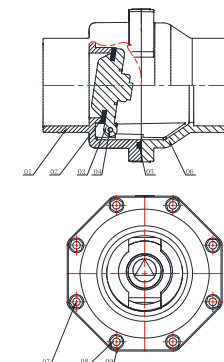

## GENERAL BUTTERFLY VALVE(HANDLED TYPE)

### 手动通用蝶阀

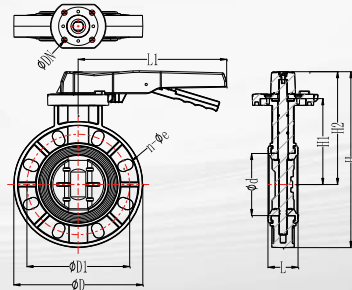

### 产品介绍

#### 阀门描述 Valve description

1. 材质: UPVC/PVC-M  
Material: UPVC/PVC-M
2. 尺寸: DN50-200  
Size: DN50-200
3. 标准: 国标  
Standard: DIN
4. 连接: 法兰  
Connection: flange
5. 颜色: 把手红色, 本体: 深灰  
Color: handle red, body: dark gray

#### 产品特性 Product Features

1. 符合饮用水标准  
Meet drinking water standards
2. 开关扭力小  
Switch torque is small
3. 部件可更换, 简单经济  
Parts can be replaced, simple and economical
4. 材料经过纳米改性, 提高产品的耐压性及抗冲击性  
The material is nano-modified to improve the pressure resistance and impact resistance of the product
5. 阀体加厚处理, 抗压性能高  
Thickened valve body for high compression resistance
6. 阀门出厂 100% 压力测试  
Valve factory 100% pressure test
7. 本体和密封经过特殊处理, 性能更好  
And a sealing body specially treated, better performance

### 产品参数

尺寸 Size DN(De)	外形尺寸 Dimensions (mm)										公称压力 Nominal Pressure PN(kg/cm <sup>2</sup> )
	D	D1	d	L	DN	L1	H1	H2	H	n-Φe	
50(63)	159.50	125.00	62.20	39.00	70.00	215.80	99.45	143.35	223.00	4-19	10
65(75)	180.00	145.00	78.70	36.00	70.00	215.80	111.50	155.40	245.40	4-19	10
80(90)	196.00	160.00	92.10	42.00	70.00	215.80	127.00	170.90	268.90	8-19	10
100(110)	229.60	180.00	111.90	46.00	70.00	264.20	156.25	205.15	320.00	8-19	10
125(140)	255.00	210.00	137.90	53.00	70.00	264.20	174.00	222.90	350.40	8-19	10
150(160)	281.50	240.00	157.35	59.40	70/102	305.40	190.00	250.60	391.35	8-23	10
200(225)	342.60	295.00	214.20	76.00	70/102	303.27	229.00	280.60	460.90	8-23	10

序号 No.	名称 Name	数量 Quantity	材料 Material
01	阀体 Body	1	PVC-U
02	阀座 Seat seal	1	EPDM
03	阀板 Disc	1	PVC-U
04	O型圈 O-ring	2	EPDM
05	齿轮盘 Plate	1	PVC-U
06	手柄 Handle	1	PVC-U
07	副把 Lever	1	PVC-U
08	销钉 Set pin	1	STEEL
09	商标盖 Logo cap	1	PVC-U
10	螺丝 Screw	1	STEEL
11	阀杆 Shaft	1	STEEL

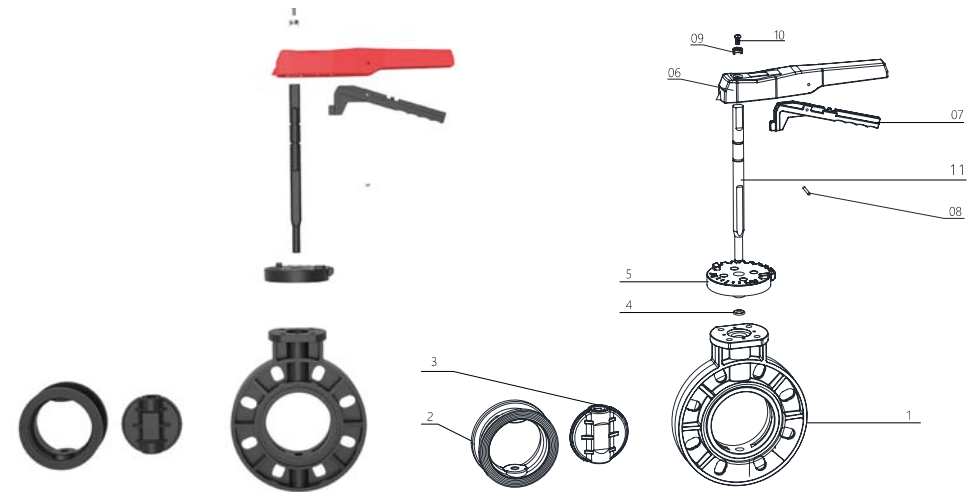

## GENERAL BUTTERFLY VALVE(GEARED TYPE)

### 齿轮式通用蝶阀

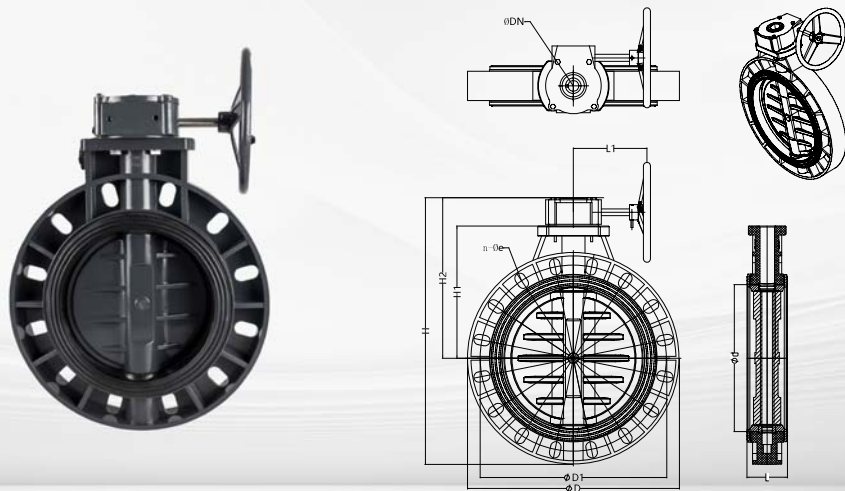

#### 产品介绍

##### 阀门描述 Valve description

1. 材质: UPVC/PVC-M  
Material: UPVC/PVC-M

2. 尺寸: DN100-400  
Size: DN100-400

3. 标准: 国标  
Standard: DIN

4. 连接: 法兰  
Connection: flange

5. 颜色: 涡轮头黑色, 本体: 深灰  
Color: turbine head black, body: dark gray

##### 产品特性 Product Features

1. 符合饮用水标准  
Meet drinking water standards

2. 开关扭力小  
Switch torque is small

3. 部件可更换, 简单经济  
Parts can be replaced, simple and economical

4. 材料经过纳米改性, 提高产品的耐压性及抗冲击性  
The material is nano-modified to improve the pressure resistance and impact resistance of the product

5. 阀体加厚处理, 抗压性能高  
Thickened valve body for high compression resistance

6. 阀门出厂 100% 压力测试  
Valve factory 100% pressure test

7. 本体和密封经过特殊处理, 性能更好  
And a sealing body specially treated, better performance

#### 产品参数

尺寸 Size De	外形尺寸 Dimensions (mm)										公称压力 Nominal Pressure PN(kg/cm <sup>2</sup> )
	D	D1	d	L	DN	L1	H1	H2	H	n-φe	
100(110)	229.60	180.00	111.90	46.00	70.00	216.00	156.20	205.15	320.00	8-19	10
125(140)	255.00	210.00	137.90	53.00	70.00	216.00	174.00	222.90	350.40	8-19	10
150(160)	281.50	240.00	157.35	59.40	70.00	216.00	190.00	250.63	391.35	8-23	10
200(225)	242.60	295.00	214.20	76.00	70 / 102	190.00	229.00	299.00	470.00	8-23	10
250(280)	409.65	355.00	250.00	85.00	102.00	190.00	264.00	334.00	540.00	12-22	8
300(315)	483.55	400.00	290.00	92.00	102.00	190.00	301.50	371.50	613.00	12-22	8
350(355)	510.00	450.00	370.00	95.00	102.00	190.00	330.00	410.00	660.00	16-27	6
400(400)	570.00	500.00	420.00	95.00	140.00	190.00	360.00	440.00	730.00	16-30	6

序号 No.	名称 Name	数量 Quantity	材料 Material
01	阀体 Body	1	PVC-U
02	阀板 Disc	1	PVC-U
03	阀座 Seat seal	1	EPDM
04	O型圈 O-ring	3	EPDM
05	阀杆 Shaft	1	STEEL
06	键销 Key pin	1	STEEL
07	涡轮执行器 Gear	1	STEEL

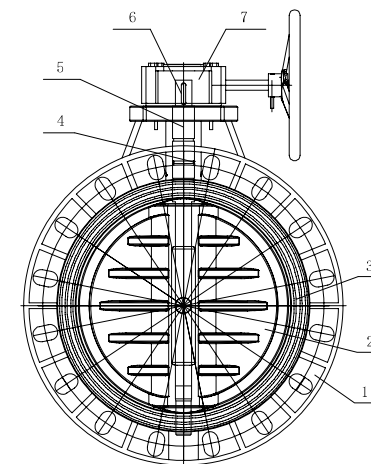



## SAMPLING VALVE

### 取样阀

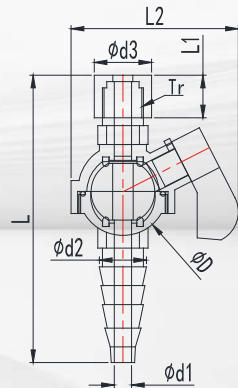

## 产品参数

尺寸 Size (*")	外形尺寸 Dimensions (mm)							
	D	d1	d2	d3	L	L1	L2	Tr
1/4"	28.50	5.50	15.00	20.00	94.00	16.00	53.50	1/4"

序号 No.	名称 Name	数量 Quantity	材料 Material
01	螺帽 Nut	1	PVC-U/C
02	阀体 Body	1	PVC-U/C
03	胶圈 Ring	1	EPDM/FPM
04	球心 Ball	1	PVC-U/C
05	胶圈 Ring	1	EPDM/FPM
06	胶圈 Ring	1	EPDM/FPM
07	阀嘴 Nozzle	1	PVC-U/C
08	手柄 Lever	1	PVC-U

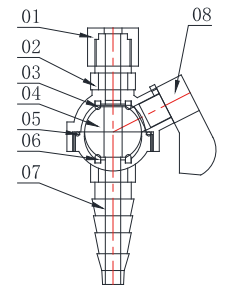

# EXPERT IN PIPING SYSTEM

## 管路系统的专家级工厂



微信公众号二维码



企业网站二维码

 24h 400-928-1588

### 华生管道科技有限公司

地址：常州市新北区空港产业园旺贤路9号(213133)

电话：+86 519-85201808 83201080

传真：+86 519-83201088 83201026

邮箱：sales@czhuasheng.com

info@czhuasheng.com

网址：www.czhuasheng.com

### HUASHENG PIPELINE TECHNOLOGY CO., LTD

Address: NO.9, Wangxian Road, Konggang Industry Park, Xinbei District, Changzhou, 213133, China

Tel: +86 519-85201808 83201080

Fax: +86 519-83201088 83201026

Email: sales@czhuasheng.com

info@czhuasheng.com

Web: www.huashengpipe.com

© 华生管道科技有限公司拥有该资料著作权及相关权利，未经授权人许可，不得擅自复制、发布、改编，或者向公众传播。  
Huasheng Pipeline Technology Co., Ltd. owns copyright and related rights, and the data, without the consent of the obligee shall not, without copying, Distribution, adapted, or transmitted to the public.